

## HS150

Table Hole Mount Angled Stand  
HS155

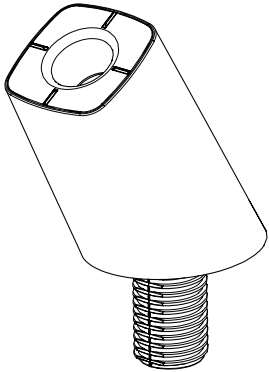

- 1 Drill a 29 mm (1.125") hole in fixture. Wipe fixture with alcohol wipe provided. **Let it dry completely.**

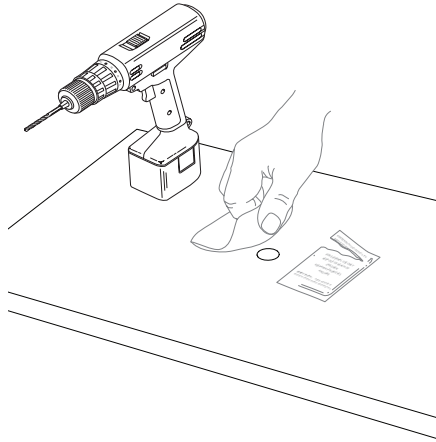

- 2 Remove clip from stand.

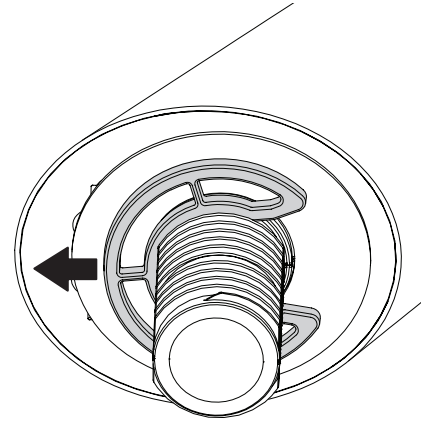

- 3 Remove clear film from adhesive on bottom of stand.

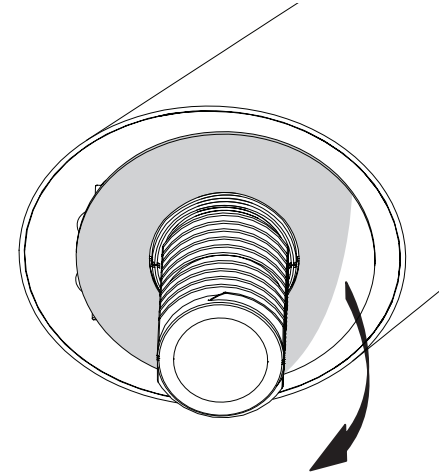

- 4 **Optional:** If fixture hole is greater than 48 mm (1.9"), return clip to stand.

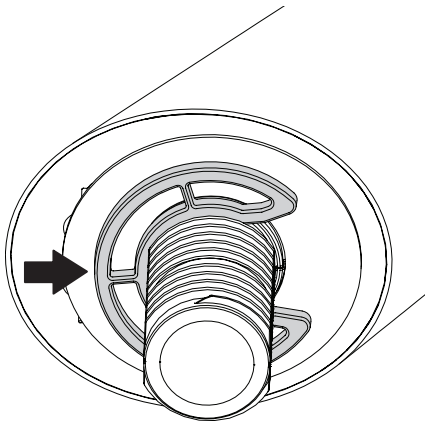

- 5 Slide stand through fixture.

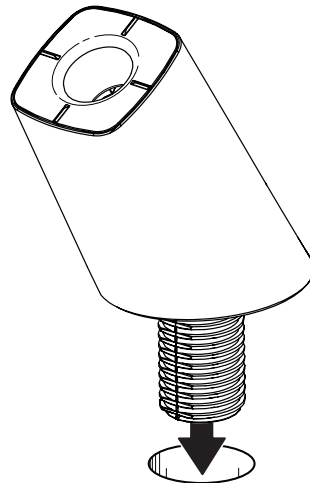

- 6 **Below fixture:** Fully tighten plastic nut onto stand.

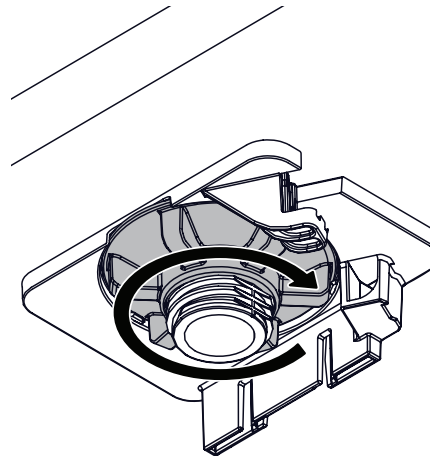

- 7 Slide sensor cable through top of stand.

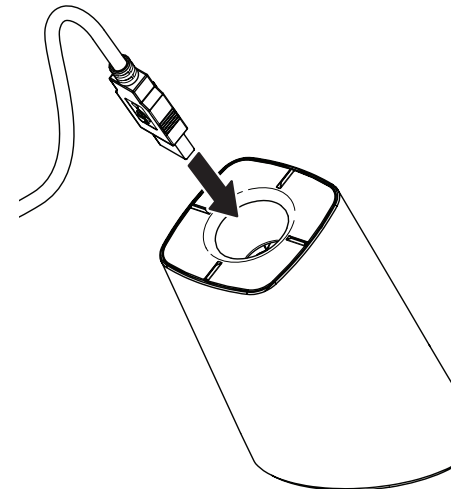

8

**Below fixture:** Slide stopper onto sensor cable.

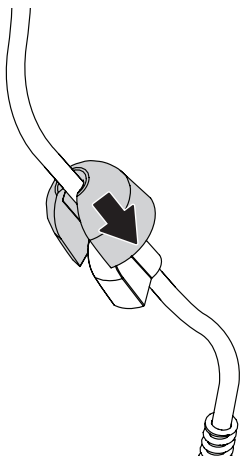

9

Firmly plug sensor cable into plastic nut assembly and pull on cable to confirm it is locked in.

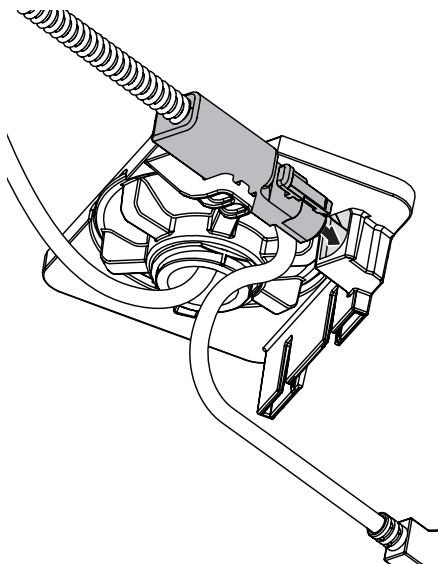

10

Plug power supply into sensor cable and outlet.

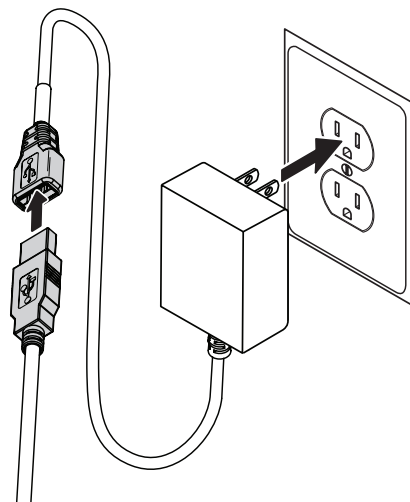

SD0279 Rev3 07/13/15

**inVUE**

[www.invuesecurity.com](http://www.invuesecurity.com)

NA / LATAM // 704.752.6513 • 888.55.INVUE

EMEA // +31.23.8900150

APAC // +852.3127.6811

© 2015 InVue Security Products Inc. All rights reserved.  
InVue is a registered trademark of InVue Security Products.