

## W1000

Wearables Stand Band Sensor

DVW100-W

DVW100-B

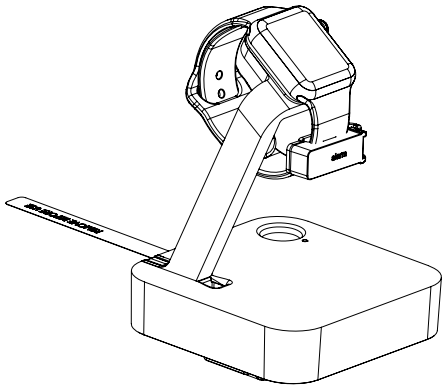

- 1 Remove screw with T-8 bit. Take off band sensor cover.

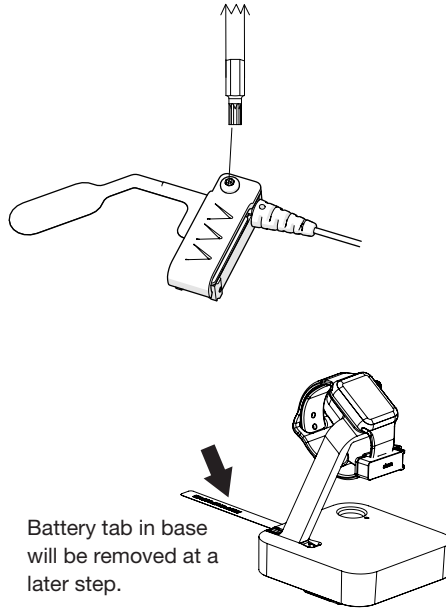

- 2 Peel back rubber pad and remove the paper sensor.

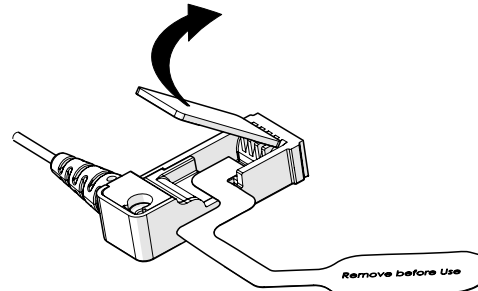

- 3 Place tear sensor as shown, first pressing down and then sliding it into position.

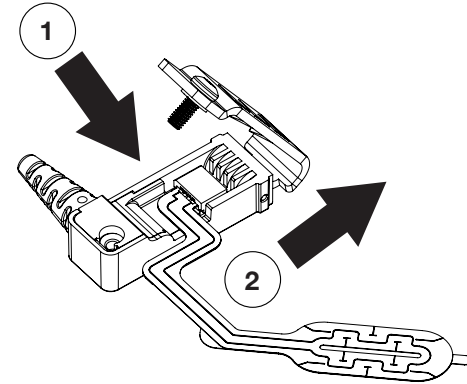

- 4 Replace rubber pad.

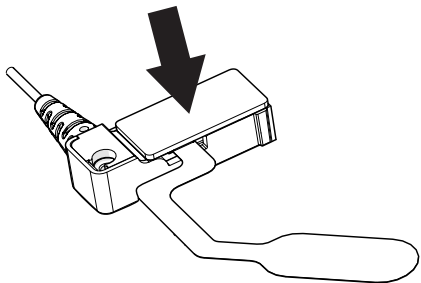

- 5 Wipe back of wearable. Align tear sensor to be parallel with wearable band.

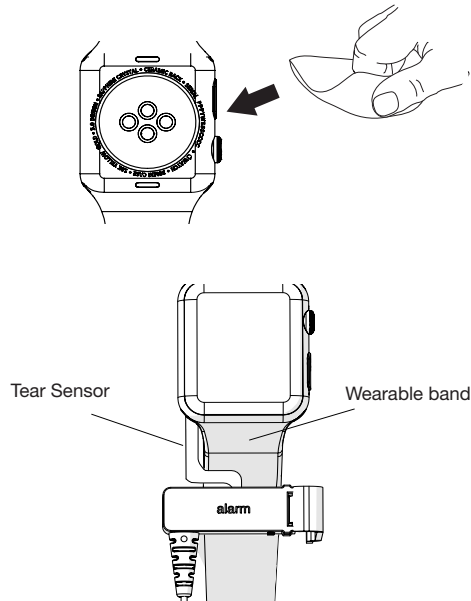

- 6 Peel adhesive liner. Press sensor onto back of wearable, ensuring that it's placed as shown below.

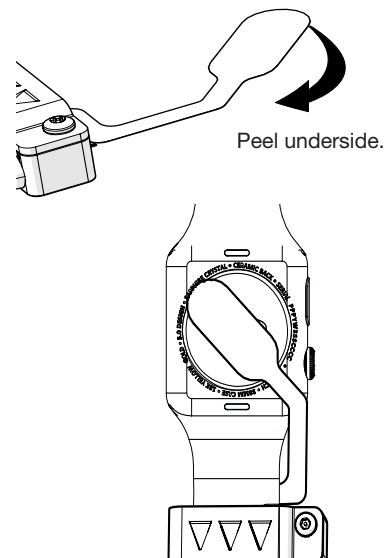

- 7 Reinsert band sensor cover onto band sensor. Place wearable band into band sensor and close the band sensor cover around it.

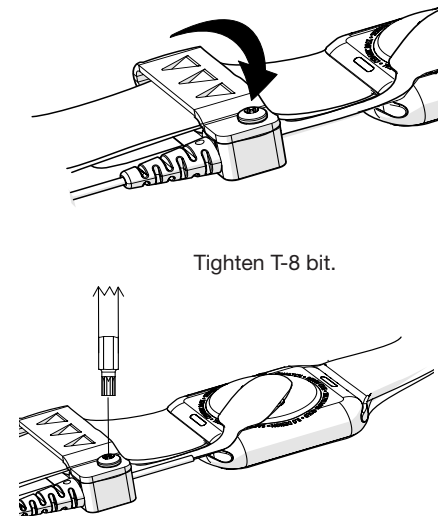

- 8 Wipe the W1000 Stem with alcohol wipe provided. **Let dry completely.**

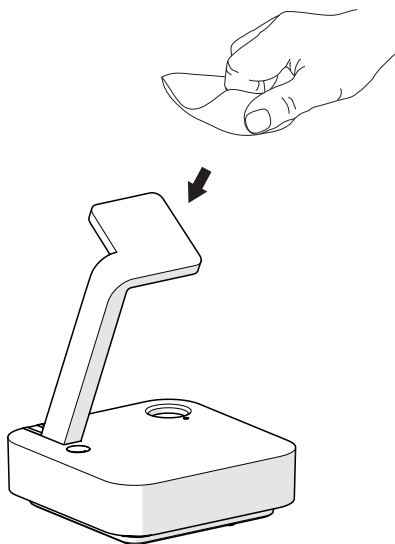

- 9 **If mounting with OEM charger**, peel adhesive dot and place onto stem. Press charger firmly onto stem for 10 seconds.

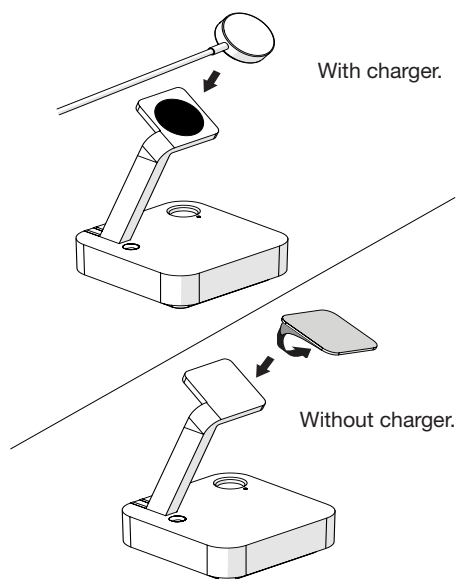

- 10 Remove the cable cover from the WS2 stem and route the OEM charger cable into the channel as shown. Replace the cable cover to its original position to hold the cable in place.

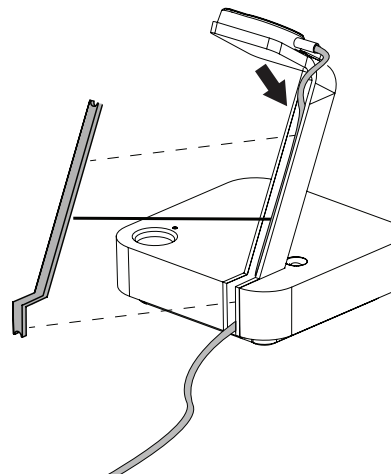

- 11 Route cable as desired.

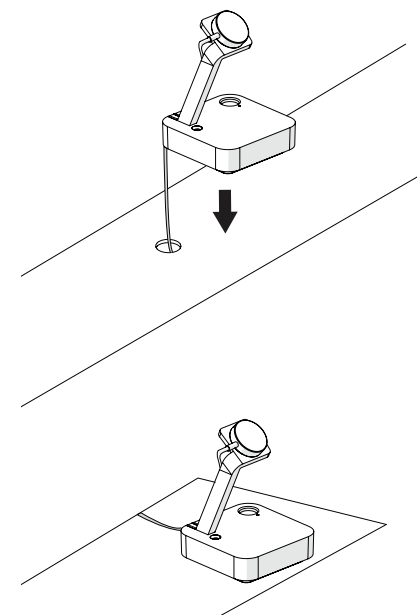

- 12 Plug in OEM charger. Ensure that watch is receiving power.

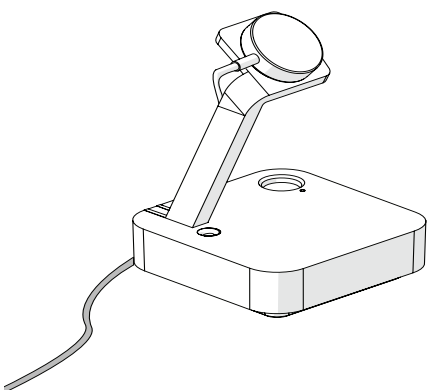

- 13 Pull battery tab.

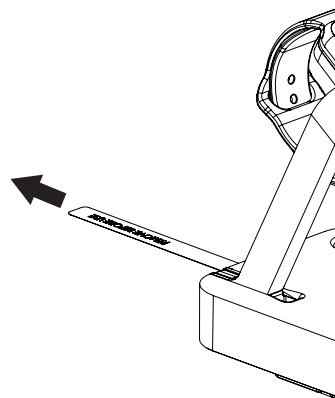

- 14 Peel adhesive liner from base, press firmly for at least 10 seconds onto fixture.

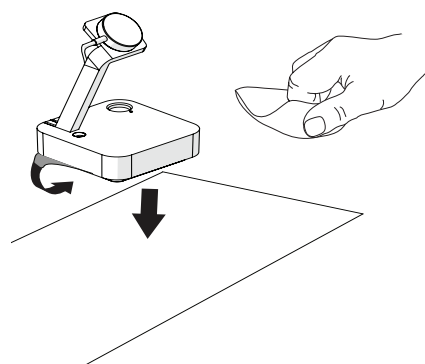

**Note:** If using slot mount, see separate instructions.

SD0380 Rev1 08/04/2016

**inVue**

[www.invue.com](http://www.invue.com)

NA / LATAM // 704.752.6513 • 888.55.INVUE

EMEA // +31.23.8900150

APAC // +852.3127.6811