

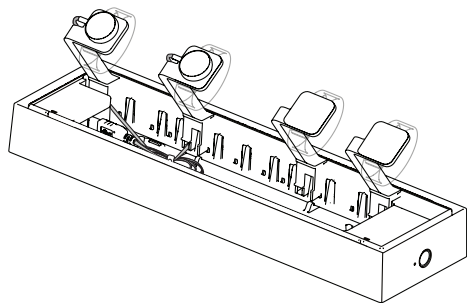

J704 Alarming Showcase

Wearable Stems



If mounting with cradle accessory, see cradle instructions.

- 4A** Peel clear film from silicon pad and apply to center of stem head. Press firmly for 10 seconds.

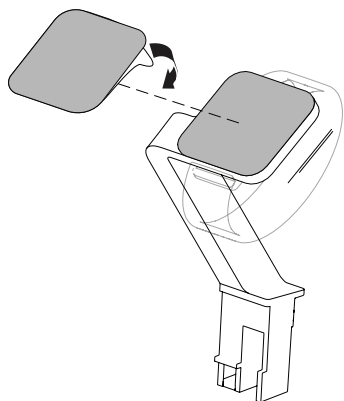

- 1** If using optional band form, wipe back of stem head with alcohol wipe provided. **Let dry completely.** Peel clear film from band form adhesive.

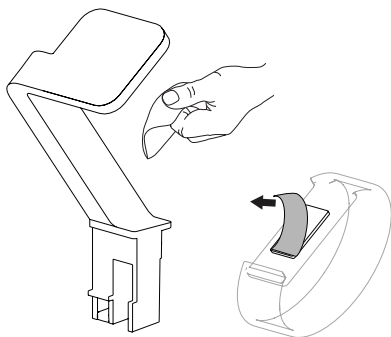

Note: If displaying watch that requires horizontal orientation for charging, proceed to step 14.

- 5A** Insert stem cover into channel on back of stem.

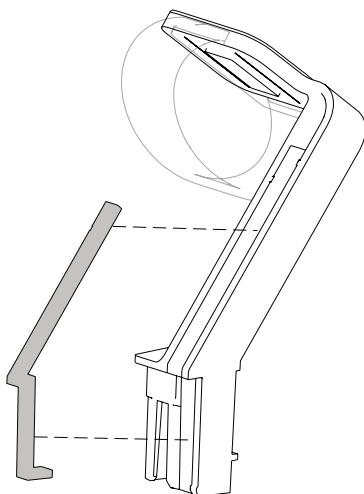

Go to step 9.

- 2** Align band form to the back of the stem head and press adhesive for at least ten seconds.

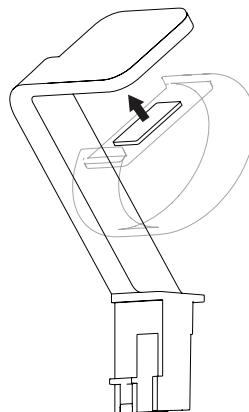

Mounting Without Charger (Option A)

- 3A** If mounting device without charger, wipe stem head with alcohol wipe provided. **Let dry completely.**



Mounting OEM Charger (Option B)

- 3B** Wipe stem head and underside of charger with alcohol wipe provided. **Let dry completely.**



- 4B** Peel clear film from circular adhesive and apply to center of stem head. Press firmly for 10 seconds.

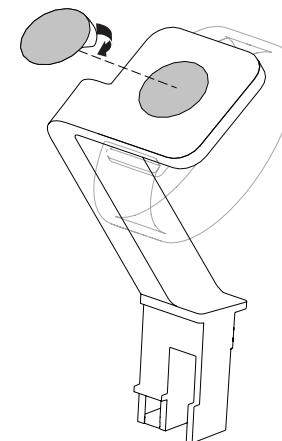

- 5B** Check orientation of watch in relation to charger. Align charging cable to stem side.

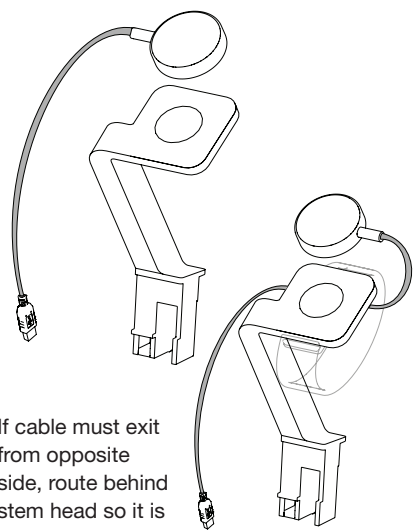

If cable must exit from opposite side, route behind stem head so it is positioned near the stem.

- 6B** Peel clear film from adhesive and place charger onto center of stem head. Press firmly for at least ten seconds.

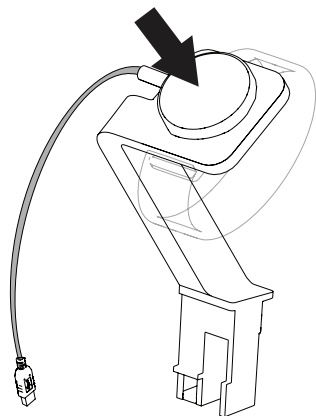

- 7B** Route power cable into notch in stem. Ensure cable is routed the full length of the stem. Install the stem cover.

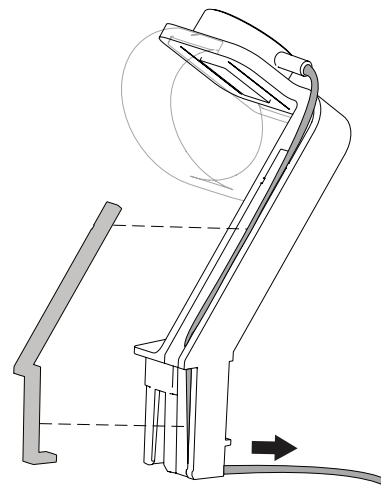

Note: Cable exits from front of stem.

- 8B** Bundle cable using cable tie provided.

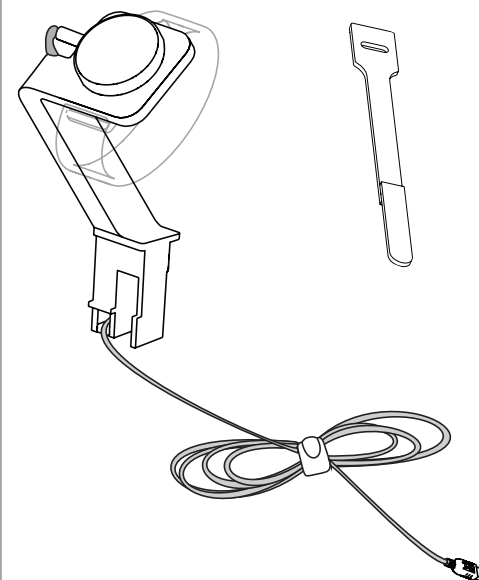

- 9** Decide how many watches will be displayed in J704-Secure Showcase. Follow guide sticker in base unit for recommended positioning. Install stems in positions with corresponding colors.

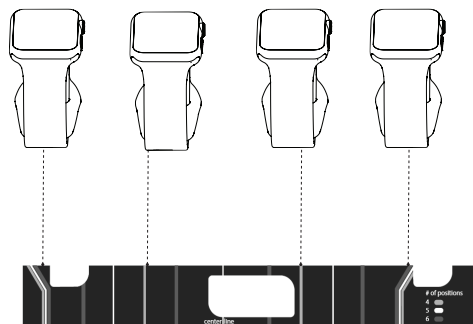

- 10** Insert stem into slot and push down until stem snaps into place. Make sure cable is positioned towards front of base unit.

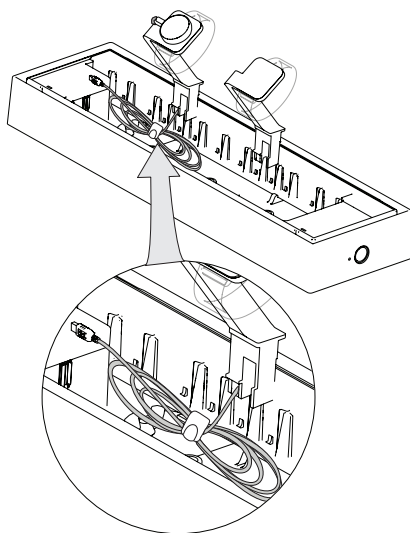

- 11** Locate USB port nearest to watch stem and insert OEM charging cable USB connector. **Note: Watches only.**

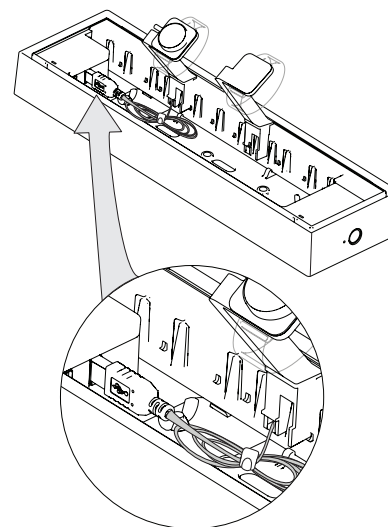

- 12** Repeat for remaining watch stems.

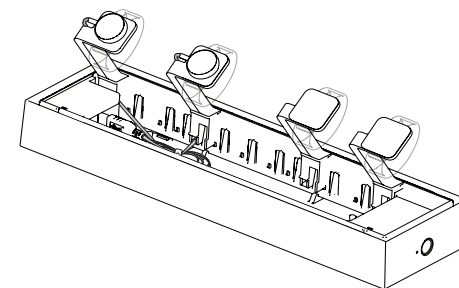

- 13** Place wearables onto corresponding chargers. Continue with base unit instructions.

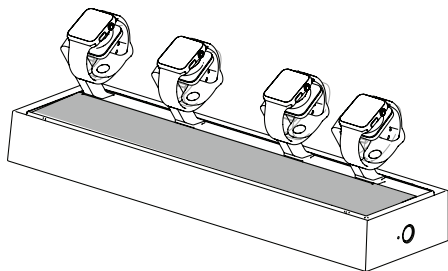

Mounting Horizontal OEM Charger

- 14** Bundle cable using cable tie provided.

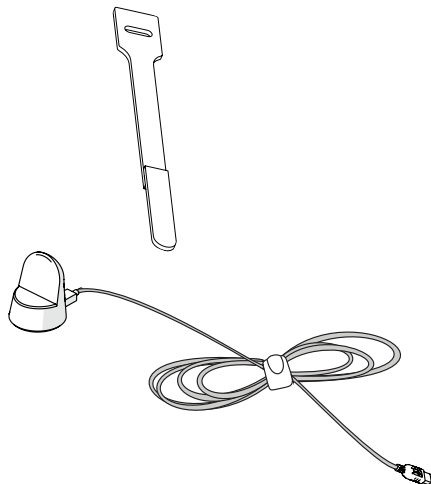

- 15** Plug OEM USB connector into nearest available USB port. Position charging pad towards rear of base unit.

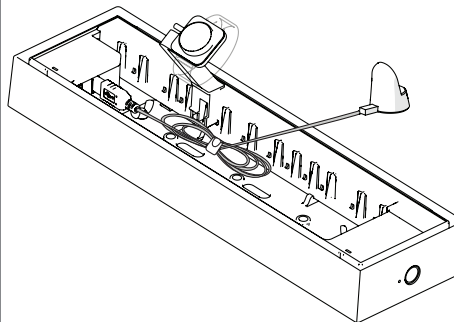

- 16** With trim cover in place (see base unit instructions), put charger in desired display position on trim cover to see its relationship to other devices in Secure Showcase. Place watch on charger to ensure band doesn't hang over back of unit.

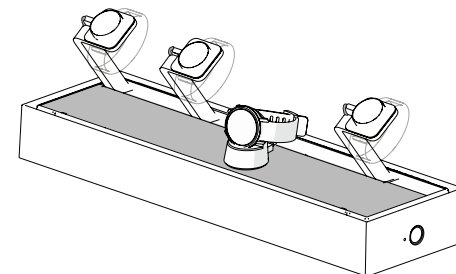

- 17** Use round adhesive provided with stem to adhere charger to trim cover, pressing firmly for at least ten seconds. Continue with base unit instructions.

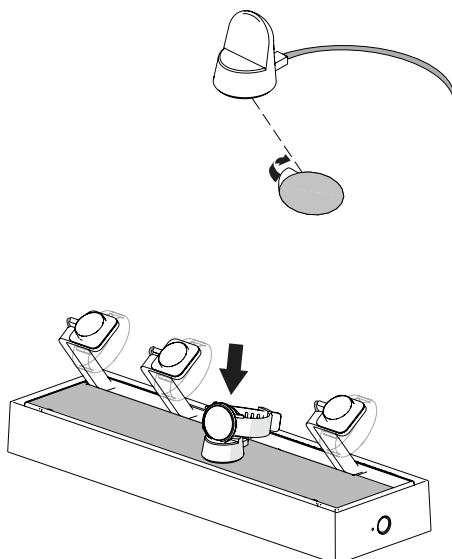

SD0358 Rev2 10/3/16

inVue

www.invue.com

NA / LATAM // 704.752.6513 • 888.55.INVUE

EMEA // +31.23.8900150

APAC // +852.3127.6811

© 2016 InVue Security Products Inc. All rights reserved.
InVue is a registered trademark of InVue Security Products.