

CT50

Basic Commercial Tablet Stand
CT000

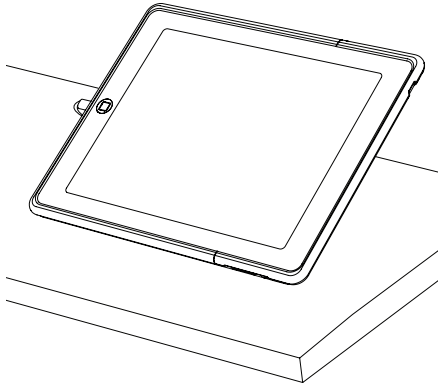

- 1 Drill a 19 mm (0.75") hole in display counter. Wipe display counter with alcohol wipe provided. **Let it dry completely.**

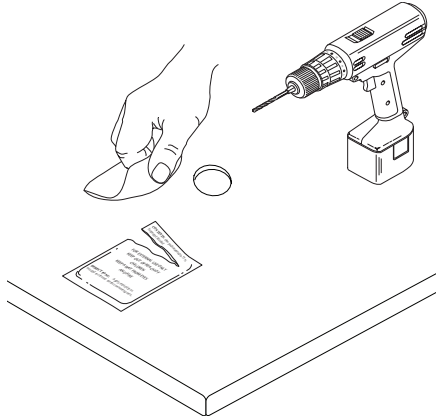

- 2 **For iPad Air 2 only:** Attach all 4 spacers onto shroud before moving to step 3.

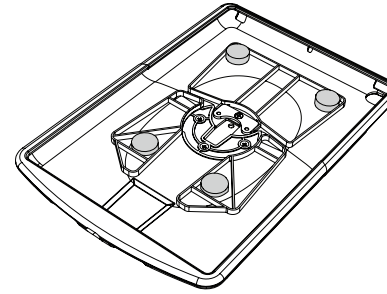

- 3 Slide tablet into shroud. Slide top of shroud onto tablet. Firmly squeeze shroud to enclose tablet and tighten screw with T-20 bit or Phillips screwdriver.

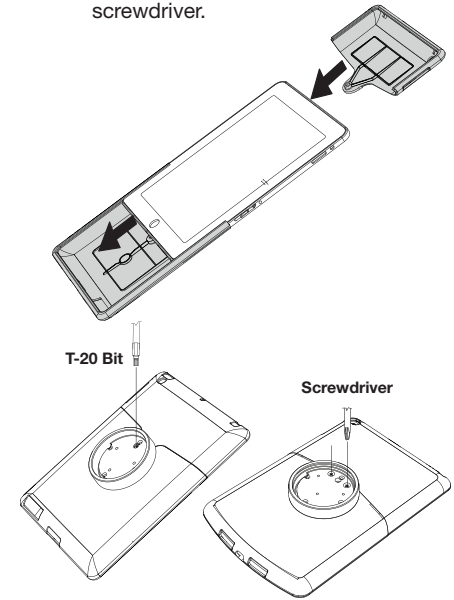

- 4 Slide OEM power supply through hole. Leave approximately 254 mm (10") of cord above counter.

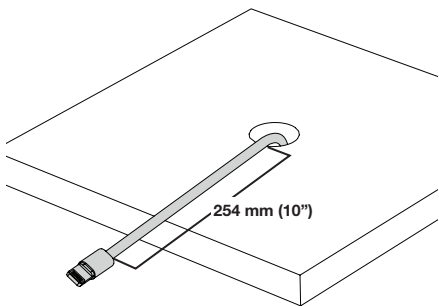

- 5 Remove adhesive film on stand and slide stand through hole. Make sure OEM power supply cord is tucked in groove on bottom of stand.
Note: OEM power supply cord can be hidden with clip (see step 14).

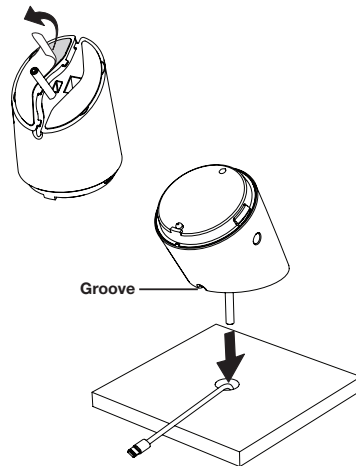

- 6 Slide security washer and metal washer onto stand below counter. **Loosely tighten washer.**

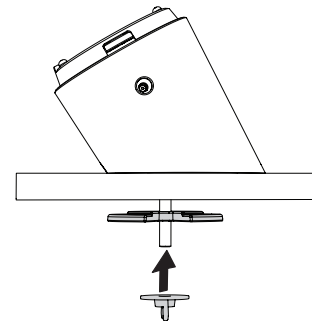

- 7 Confirm power button is towards bottom of stand and snap shroud onto stand. You should hear a "click." Confirm shroud is locked on stand by pulling on shroud.

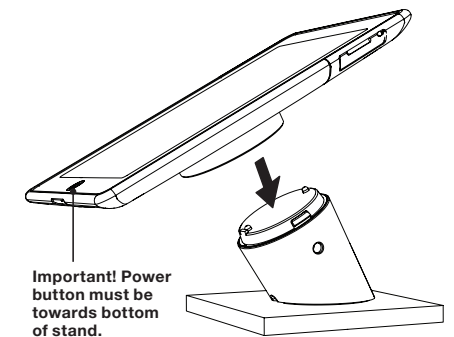

- 8** Confirm shroud is aligned correctly and straight with front of display counter. Fully tighten washer.
- 9** Plug OEM power supply to tablet.

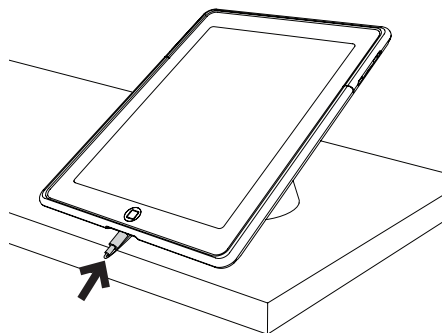
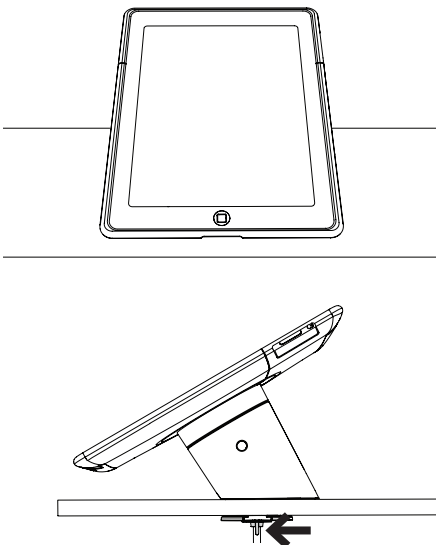

- 10** Depending on shroud ordered, use either clip or magnetic medallion (step 10 or 11).
A) Optional for cord management (clip): Remove adhesive film from clip. Place clip with open end facing metal ring onto shroud and press firmly.

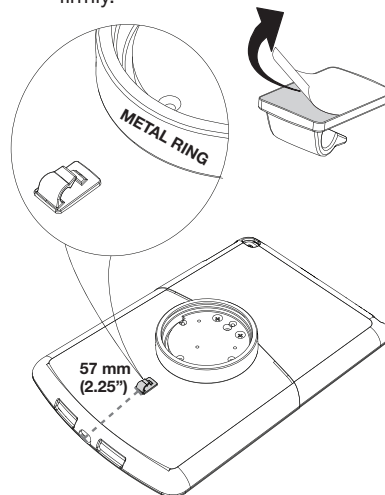

- B) Optional for cord management (clip):** Tuck OEM power supply cord into clip.

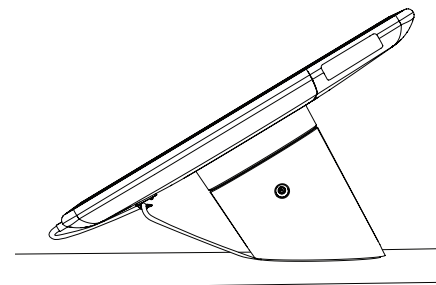

- 11** **Optional for cord management (medallion):** Remove adhesive film from magnet. Place cord in medallion at least 5" from connector. Place magnet adhesive side down on cord and press firmly. Place magnetic medallion with cord below shroud.

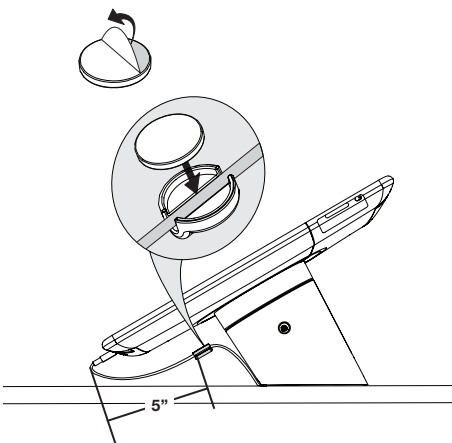

- 12** Rotate shroud 90 degrees to display in landscape.

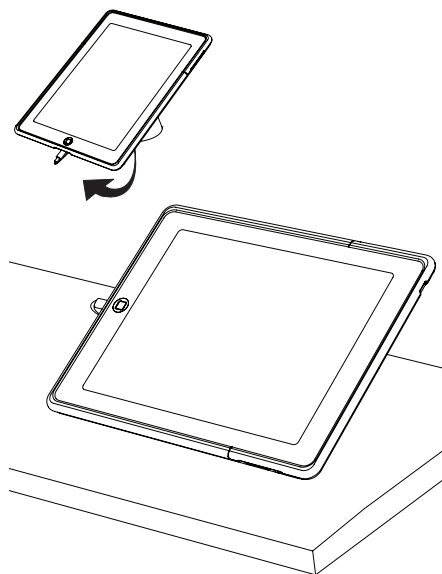

- 13** To remove shroud from stand, insert key with "InVue" facing towards you and turn 1/4 to unlock shroud.

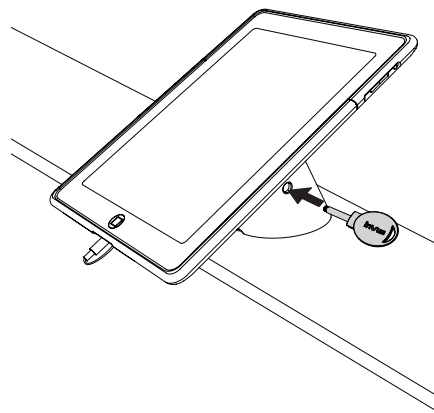

SD0169 Rev2 03/09/15

inVue

www.invuesecurity.com

NA / LATAM // 704.752.6513 • 888.55.INVUE

EMEA // +31.23.8900150

APAC // +852.3127.6811