

W1000 Slot Mount

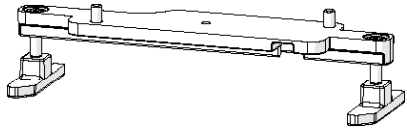

- 1 Decide which two screws will be used in the slot mount.

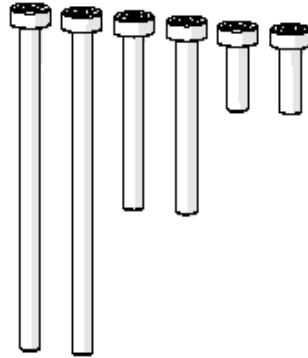

Note: Do not remove adhesive liner - stand does not need to adhere to counter top.

- 2 Insert two screws at the top of the W1000 slot mount. Place two nuts at the bottom of two screws just inserted and twist on.

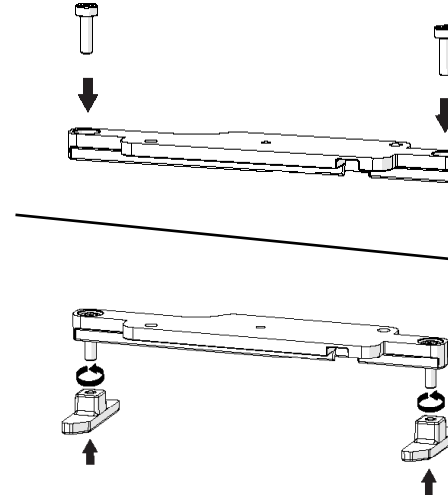

- 3 Attach the Slot Mount Kit to the bottom of WS2 using two screws with a multi tool.

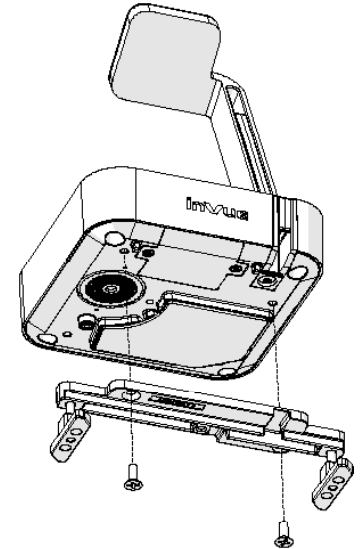

- 4 Slot mount should be attached as shown. The bracket should not cover piezo.

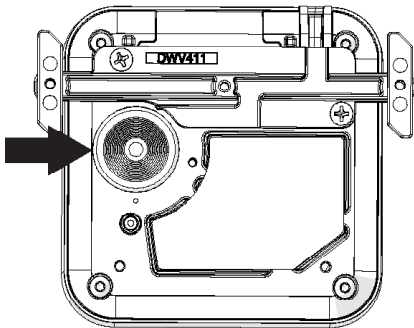

- 5 Align nuts parallel to slot.

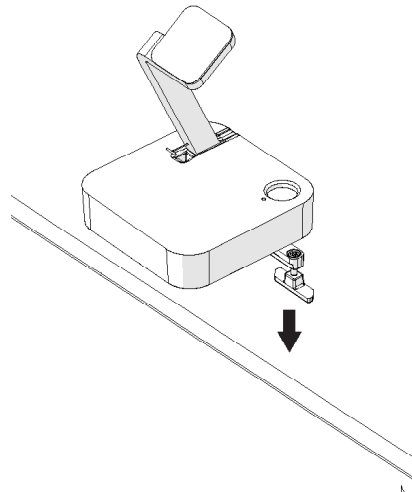

- 6 Set W1000 into place on slot and tighten two screws with T20 bit in multi-tool.

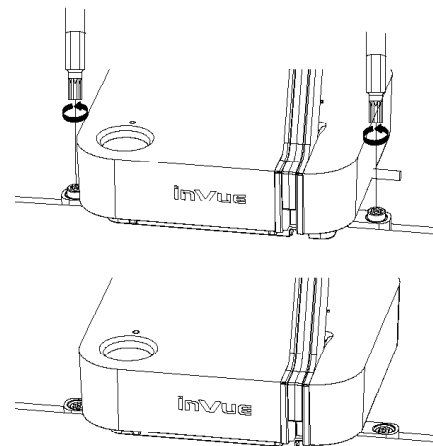

SD0388 Rev0 08/08/16

inVUE®

www.invue.com

NA / LATAM // 704.752.6513 • 888.55.INVUE

EMEA // +31.23.8900150

APAC // +852.3127.6811